



KONICA MINOLTA

Giving Shape to Ideas

PRODUCTIVITY & PERFORMANCE ELEVATED



- bh558 B&W 55 ppm
- bh458 B&W 45 ppm
- PRINT
- COPY
- Scan 160 OPM Duplex
- Scan 80 OPM Simplex
- SCAN TO USB
- USB Print
- Colour Internet Fax
- Fax
- MOBILE SUPPORT
- AirPrint
- Google Cloud Print Ready
- PRINT WITH ANDROID
- mopria
- KMPS
- INFO-Palette
- Biometric Authentication
- IC-Card Authentication
- Emperon Driven!
- Bioplastic
- Recycled PC/PET
- PageScope Mobile
- Simitri with Biomass

A3 Monochrome Multifunctional Printer
bizhub 558/458

*Optional

Boost Everyday Business Productivity

Achieve higher productivity with Konica Minolta bizhub 558/458. Swiftly output monochrome documents at high resolution. Intuitively take advantage of feature-rich capabilities, securely handle confidential business data and flexibly complete high-volume jobs with advanced paper finishing options. Professional quality production of business documents has never been easier.



1 bizhub 558/458

22 sec.

Warm-up time
22 seconds or less on bizhub 558
(25 seconds or less on bizhub 458)

160 OPM

Single-pass duplex scanning

3.5 sec.

First copy time
bizhub 558 (4.0 seconds on bizhub 458)

55 ppm

Output
bizhub 558 (45 ppm on bizhub 458)

Finisher FS-537/FS-537SD

The newly developed optional FS-537/FS-537SD multi-function finisher handles a wide range of post-processing tasks.



Simple, Solid Security

Flexible authentication support, easy initial security set-up and other security conveniences simplify protection of company assets.



Operational Ease and Efficiency

User-friendly Multi-touch Screen

Operation is simplified by a user-friendly 9-inch multi-touch screen with intuitive user interface. The same touch gestures used on mobile devices can be used on the touch screen to simplify operation. Tap to select, double tap to activate, flick to scroll or pinch to magnify. Up-to 23 shortcut keys can be set in the main menu for quick and easy access to frequently used functions.



INFO-Palette Design

The bizhub 558/458 adopts easy & intuitive INFO-Palette Design with smart user interface. You can get the same user experience through seamless operation across PCs, Tablets or Smartphones.

Paper Capacity

The standard 1,150-sheet paper capacity can be increased to 3,650 sheets by adding the optional Paper Feed Cabinet. It can be further increased to 6,650 sheets by adding another optional Large Capacity Unit. Higher capacities let users handle higher-volume workloads with less downtime for paper replenishment.

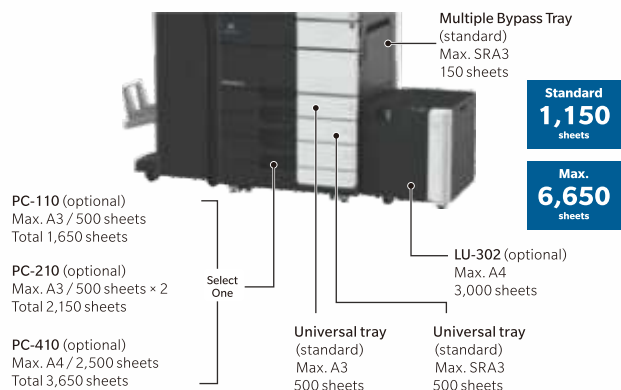

*The paper supply capacity for all models is based on 80 gsm

High-speed Colour Scanning

Colour hardcopies are scanned with precision and speed on standard Dual Scan Document Feeder DF-704. Just place hardcopies in the feeder and press the Scan button to scan one-sided pages at 80 OPM (simplex) and two-sided pages at 160 OPM (duplex)¹.



¹When feeding A4 paper sideways (at 300 dpi resolution)

Hardcopy Digitisation

Scanned hardcopies can be saved as searchable PDFs¹ or editable files in the PowerPoint, Excel or Word format². The files are small with excellent image quality and can be saved in the internal HDD or mobile devices.

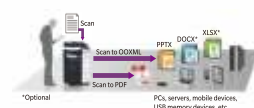

¹Optional i-Option LK-102v3 or LK-110v2 is required.

²Editable Excel/Word formats require optional i-Option LK-110v2.

Optional Finishers

Four optional finishers are available for post-processing tasks, including the newly developed FS-537/FS-537SD multi-function finisher, which handles wide range of tasks such as stapling of up to 100 sheets. Optional finishers FS-537/FS-537SD, FS-536 and FS-536SD includes a 3,000-sheets capacity unit (2,500 sheets on FS-537SD and 2,000 sheets on FS-536SD), booklet functions, folding functions and more. Optional inner finisher FS-533 handles stapling from within compact bizhub dimensions.



Features	Finishing Images	FS-537 ^{1,2}	FS-537SD ^{1,2}	FS-536 ^{1,2}	FS-537SD ^{1,2}	FS-533	JS-506
Sorting (offset sorting)	Paper output position is shifted for each set	○	○	○	○	○	○
Stapling	Corner stapling (diagonal)	○	○	○	○	○	○
	Corner stapling (parallel) ⁴	○	○	○	○	○	○
Saddle stitching (booklet) & folding	Booklet	—	Max. 20 sheets	—	Max. 20 sheets	—	—
	Centre-fold	—	—	—	—	—	—
Z-folding	Z-folding	Z-folding unit ZU-609 (52.90g/m ²)	Z-folding unit ZU-609 (52.90g/m ²)	—	—	—	—
	Letter-fold	—	—	—	—	—	—
Punching	Two-hole punch	Punch kit PK-523 (up to 300g/m ²)	Punch kit PK-523 (up to 300g/m ²)	Punch kit PK-520 (up to 300g/m ²)	Punch kit PK-520 (up to 300g/m ²)	Punch kit PK-520 (up to 300g/m ²)	—
	Upper two-hole punch	—	—	—	—	—	—
Cover sheet & insert sheet	Coversheet	Post inserter PI-507	Post inserter PI-507	—	—	—	—

¹ Paper output to the main body is possible. Up to three output destinations can be set.

² Relay unit RU-513 is required.

³ Parallel stapling is only compatible with A4/B5 vertical and A5 horizontal on FS-537/FS-537SD/FS-536/FS-536SD.

⁴ Diagonal corner stapling is not possible.

Easy Connectivity

Connect with Mobile Devices

Enjoy a flexible mobile work style by using bizhub 558/458 together with iOS, Android and Windows 10 mobile devices. Users can take advantage of printing and other bizhub features through their favorite industry standard mobile technologies (see right).

Convenient Mobile Touch Area

The bizhub 558 series has a Mobile Touch Area on the operation panel with embedded NFC (Near Field Communication) technology. NFC ensures smooth, quick connections through which you can pair Android mobile devices¹ with bizhub 558 series by simply holding them close to the Mobile Touch Area. This can also be used to log in, print files, scan documents and import scanned data². iOS devices can be paired using Bluetooth LE (BLE)³.



¹ Android OS 4.4 or higher and PageScope Mobile must be installed.

² Initial setup required for logging in. Wireless LAN environment required for printing and scanning.

³ Optional Device connection I/F kit EK-609 is required.

Wireless LAN*

Wi-Fi Direct allows computers and mobile devices in your office to wirelessly connect with bizhub 558 series. This creates a fully independent network that supports BYOD (bring your own device) without additional investment. If your office already uses a wireless corporate LAN, bizhub 558 series can easily connect with it to offer advantages to everyone in the office.

*Optional Upgrade kit UK-212 or UK-215 is required.

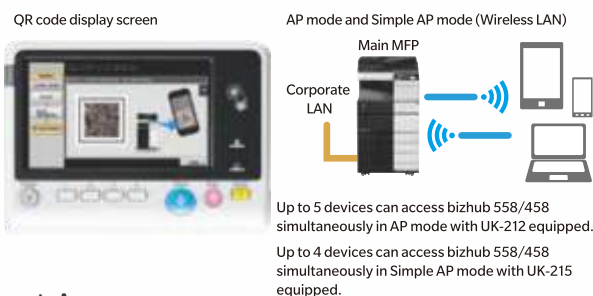

bizhub Remote Access

The bizhub Remote Access app allows operation of bizhub 558/458 from Android devices and iPhone/iPad/iPod touch. Users can wirelessly operate bizhub hardware and software keys, enter data, import scanned data, send data from bizhub 558/458 using the mobile device's address book and more.

Connect Instantly Without Print Drivers to Industry Standard Mobile Technologies

	iOS	Android	Windows 10 Mobile
AirPrint Print from any compatible Apple iOS device on your company's wireless LAN using AirPrint. Apple's standard printing system. It is compatible with iOS 4.2 and Mac OS 10.7 or later.	✓		
Mopria Print Service This wireless printing technology provides a universal print driver for printing from devices installed with Android 4.4 or later.		✓	
Google Cloud Print Leading technology connects bizhub 558/458 with the web so users can print from anywhere outside the office regardless of OS, device or application. Note: Google Cloud Print Setup and Google account registration are required.	✓	✓	
Konica Minolta PrintService This application enables printing directly from devices running Android 4.4 or later through your company's wireless LAN.		✓	
PageScope Mobile Connect mobile devices with bizhub 558/458 via Wi-Fi to print documents and images as well as import scanned data — by using PageScope Mobile for Android or iPhone/iPad.	✓	✓	✓



Solid Security

Easy Authentication

Smooth and efficient authentication¹ by means of password, IC card and biometric (finger vein) options are supported. In addition to regular authentication via server, server-free authentication can also be performed directly on the main unit with detailed control of access to each function, including copying, printing, scanning and faxing. These features complement your company's existing security measures to protect important data and hardcopy resources, prevent unauthorised bizhub access and strengthen risk management.

IC Card Authentication

Authentication is possible with various types of IC card. First command bizhub 558/458 to print from a PC or mobile device. Then wave the ID card over a card reader on bizhub 558/458 to print. Authentication can also be performed with any Android device* equipped with an NFC antenna.

*Requires Android 4.4 or later that supports HCE (Host Card Emulation) or PageScope Mobile for Android v4.1 or later.

Notes: Optional Authentication Unit AU-201S is required. Compliant non-contact IC cards include FeliCa (Idm), SSFC, FCF, FCF (campus), FeliCa Private and MIFARE (UID).



Biometric Finger-Vein Authentication

Finger vein biometric authentication is easy to implement and makes forged access virtually impossible. After commanding bizhub 558/458 to print from a PC or mobile device, the authorised user just scans his or her finger at bizhub 558/458 to print.

Note: Optional Biometric Authentication Unit AU-102 and Working Table WT-506 are required.



TPM (Trusted Platform Module)

Confidential information such as certificates and passwords can be securely managed in bizhub 558/458. Just activate the TPM function to encrypt the information and save it in a dedicated storage area in the TPM security chip. This prevents unauthorised reading from external devices.

*Optional i-Option LK-115 v2 is required.

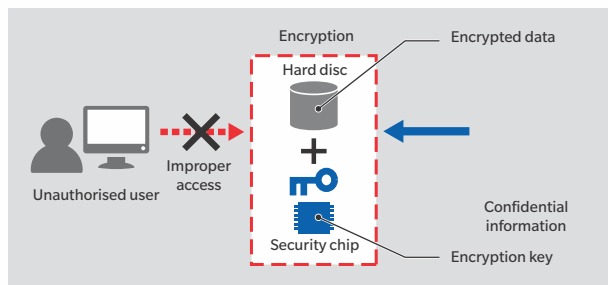

HDD Mirroring*

This feature ensures that all data saved on the main HDD is always saved on a backup HDD as well. If the main HDD fails, bizhub 558/458 automatically switches to the backup HDD to prevent operational downtime and data loss.

*Optional HDD Mirroring Kit HD-524 is required.

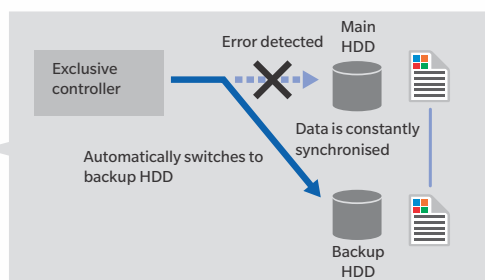

PDF Password Protection

When saving scanned data as a PDF file, the data can be encrypted to prevent opening of the file unless the user inputs the correct password. The user can also encrypt the PDF with his or her digital certificate, create a PDF/A-based PDF file* and add file properties.

*Optional i-Option LK-102 v3 or LK-110 v2 is required.

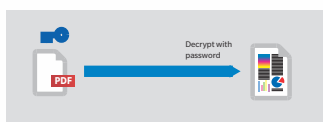

Compliance with industry Standards*

This model meets IEEE 2600.1 international protection profile standards, ensuring a high level of document security. All security features have been independently evaluated and certified ISO 15408 EAL3 compliant.

*Application is still pending as of October 2016

Versatile Features

Emperon Printing System

Emperon print controller provides network printing functions through standardised printer drivers for PCL and Adobe® PostScript® 3 emulation. Diverse settings allow fine image adjustment such as for glossy mode and edge enhancement. Emperon controller is fully compatible with Windows, Mac, Linux, Unix, Citrix, SAP and other operating systems and printing environments.



N-in-One Copying

It's easy to copy multiple pages on a single sheet of paper to reduce paper costs and facilitate viewing of related pages. Users can copy up to 8 pages on a single side of paper when scanning a paper document and up to 16 pages when printing from a file.

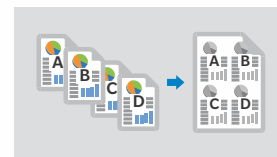

Banner Print*

Create appealing promotional materials in-house on bizhub 558/458 through the banner print feature that enables you to print on long paper (up to 1,200m) from by pass tray.

*Requires Optional Banner Paper Setting Guide MK-713.



USB Port

The USB port allows transferring of files to and from bizhub 558/458 via flash drive. Once a file is stored in bizhub 558/458, it can be used to output documents or transferred to other devices.

Notes: Compatible with PDF, Compact PDF, JPEG, TIFF, XPS, Compact XPS, OOXML (docx, xlsx, pptx) files. Some USB flash drives may not be compatible. Print output may differ from what appears on the PC screen.



ID Copy

This feature makes it easy to print in one pass, the front and back of an ID card on the top and bottom of a single page. For easy access, place an ID Copy shortcut button on the top screen.

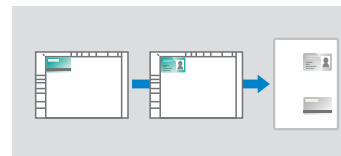

Scan Preview

Scanned paper documents can be previewed on the touch screen before saving or sending. Just flick to scroll through pages, rotate them when desired and delete unnecessary pages as required & then save or send.

Automatic Paper Size Measurement

Automatic paper size measurement feature can automatically measure the size of non-standard sized paper placed on the glass platen, if desired. It can also register the size in memory. These features make it easy for anyone to handle non-standard paper sizes without making measuring mistakes or input errors.

Server-less Pull Printing

bizhub 558/458 supports server-less pull printing. Users can send data to a main MFP and authenticate themselves at any MFP on the network print group (up to 10 MFPs x 10 groups) to pull the print job.

Note: Optional i-Option LK-114 must be installed on bizhub 558/458.

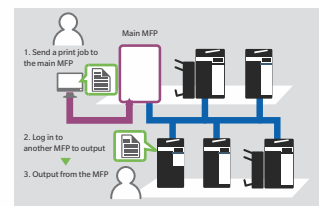

Ubiquitous printing without a server

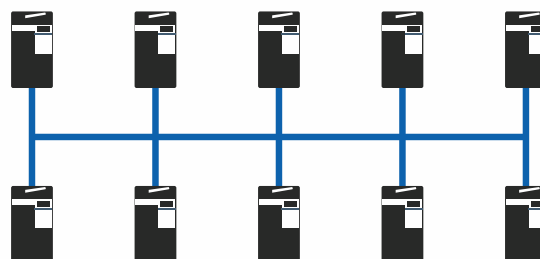

Up to 100 MFPs can be connected without a server.

Printer Specifications

Print resolution	1,800 (equivalent) x 600 dpi, 1,200 x 1,200 dpi
Page Description Language	PostScript 3 (3016) Emulation, PCL 6 (XL Version 3.0) Emulation, PCL 5e/c Emulation, XPS
Operating systems	Windows Vista (32/64), Windows 7 (32/64), Windows 8.1 (32/64), Windows 10 (32/64), Windows Server 2008 (32/64), Windows Server 2008 R2, Windows Server 2012, Windows Server 2012 R2, Macintosh OS X 10.7 or later, Linux, Unix, Citrix
Printer fonts	80 PCL, 137 PostScript 3 Emulation
Mobile printing	AirPrint (iOS), Mopria (Android), Google Cloud Print (optional), Wi-Fi Direct (optional), Konica Minolta Print Service (Android), PageScope Mobile (iOS, Android, Windows 10 Mobile)

Scanner Specifications

Scan speed ¹⁶ with DF-704	1-sided original: 80 OPM 2-sided original: 160 OPM
Resolution	Max.: 600 x 600 dpi
Scan modes	Scan to Email, Scan to PC (SMB), Scan to FTP, Scan to WebDAV, Scan to BOX (HDD), Scan to WSD (Web Service), Scan to DPWS (Device Profile for Web Service), Scan to USB memory, Network TWAIN scan
File formats	JPEG, TIFF, PDF, PDF/A-1a (optional), PDF/A 1-b (optional), compact PDF, encrypted PDF and searchable PDF (optional), XPS, compact XPS, PPTX, searchable PPTX (optional), searchable DOCX/XLSX (optional)
Destinations	2,100 (single + group), LDAP, PSDA support

¹⁶ When copying A4 or Letter (8-1/2 x 11), resolution 300 dpi

Copier Specifications

Copying process	Electrostatic laser copy, intermediate
Toner system	Simitri [®] HD Polymerized Toner
Copy/print speed A4	55 ⁸ : Up to 55 ppm, 45 ⁸ : Up to 45 ppm
1st copy out time	55 ⁸ : 3.5sec., 45 ⁸ : 4.0 sec.
Warm-up time ¹³	55 ⁸ : 22 sec. or less, 45 ⁸ : 25 sec.
Copy resolution	600 x 600 dpi
Gradation	256 gradations
Multicopy	1-9,999
Original format	A5-A3
Magnification	25-400% in 0.1% steps, auto-zooming

¹³ Warm-up time may vary depending on the operating environment and usage.

System Overview

System memory	4,096 MB (standard)
System hard disk	250 GB (standard)
Interface	10-BASE-T/100-BASE-TX/1,000-BASE-T Ethernet, USB 2.0 Wi-Fi 802.11a/b/g/n/ac (optional)
Network protocols	TCP/IP (IPv4/IPv6), NetBEUI, SMB, LPD, IPP, SNMP, HTTP
Frame types	Ethernet 802.2, Ethernet 802.3, Ethernet II, Ethernet SNAP
Automatic document feeder	Up to 100 originals, A6-A3, 35-163 gsm
Printable paper size	A6-SRA3, customised paper sizes, banner paper max. 1,200 x 297 mm
Printable paper weight	52-300 gsm
Paper input capacity	Standard: 1,150 sheets, Max.: 6,650 sheets
Tray 1	500 sheets, A5-A3, 52-256 gsm
Tray 2	500 sheets, A5-SRA3, 52-256 gsm
Tray 3 PC-110 (optional)	500 sheets, A5-A3, 52-256 gsm
Tray 4 PC-210 (optional)	2 x 500 sheets, A5-A3, 52-256 gsm
Paper feed cabinet PC-410 (optional)	2,500 sheets, A4, 52-256 gsm
Large capacity unit LU-302 (optional)	3,000 sheets, A4/Letter, 52-256 gsm
Large capacity unit LU-207 (optional)	2,500 sheets, A4/Letter - SRA3/Ledger, 52-256 gsm
Bypass tray	150 sheets, A5-SRA3, custom sizes, banner, 60-300 gsm
Automatic duplexing	A5-SRA3, 52-256 gsm
Finishing modes (optional)	Group, sort, staple, punch, output tray, booklet, centre fold, letter fold, Z-fold
Power consumption	[220-240 V, 50/60 Hz] less than 55 ⁸ : 2.00 kW, 45 ⁸ : 1.95 kW (system) [120 V, 60 Hz] less than 55 ⁸ : 1.65 kW, 45 ⁸ : 1.5 kW (system) [110 V, 50/60 Hz] less than 55 ⁸ : 1.65 kW, 45 ⁸ : 1.5 kW (system)
System dimensions	[W x D x H] 615 x 685 x 921 mm (24.2 x 27.0 x 36.3 inch) ¹¹
System weight	Approx. 93 kg (205.0 lb) ¹²

¹¹ Excluding ADF and lower paper tray unit
¹² Main Body: 81 kg (178.8 lb) + DF-704 (standard): 12 kg (26.5 lb)

Fax Specifications (optional)

Fax	Super G3
Transmission	Analog fax, Internet fax, Colour Internet fax, IP address fax
Resolution	Max.: 600 x 600 dpi (ultra-fine)
Compression method	MH, MR, MMR, JBIG
Modem speed	Up to 33.6 Kbps
Destinations	2,100 (single + group)

Components and Options

DK-510 Copier desk	Provides storage space for print media and other materials
DK-705 Caster table	Used to install this machine on the floor
MK-730 Mount kit for bypass tray	Installation kit for bypass tray
HT-509 Dehumidification heater	Dehumidification heater for Paper feed cabinet, for PC-110/210/410, DK-510
MK-734 Dehumidification heater power supply box	Dehumidification heater power supply box (Cabinet heater), for PC-110/210/410, DK-510
TK-101 Transformer kit	Required to enable the function heater of the Large capacity unit LU-207/302
OT-506 Output tray	Output tray used instead of finisher
FS-533 Inner finisher	50-sheet stapling, 500 sheets max. output
PK-519 Punch kit	For FS-533, 2/4 hole punching, Auto switching
FS-536 Staple finisher	50-sheet stapling, tray1: max. 200-sheet output, tray2: max. 3,000-sheet output
FS-536SD Staple/booklet finisher	50-sheet staple finisher, 20-sheet booklet finisher, tray1: max. 200-sheet output, tray2: max. 2,000-sheet output
PK-520 Punch kit	For FS-536/SD, 2/4 hole punching, Auto switching
FS-537 Staple finisher	100-sheet stapling, tray1: max. 200-sheet output, tray2: max. 3,000-sheet output
FS-537SD Staple/booklet finisher	100-sheet staple finisher, 40-sheet booklet finisher, tray1: max. 200-sheet output, tray2: max. 2,000-sheet output
PK-523 Punch kit	For FS-537/SD, 2/4 hole punching, Auto switching
ZU-609 Z-folding unit	For FS-537/SD, Supports the Z-fold function
JS-602 Job separator	For FS-537/SD, Separation for fax output, etc.
PI-507 Post inserter	For FS-537/SD, Inserts cover sheets into the copied or printed sheets
JS-506 Job separator	Separation for fax output etc.
RU-513 Relay unit	For FS-536/SD, FS-537/SD installation
SP-501 Stamp unit	Stamps a scanned original when sending a fax
WT-506 Working table	Authentication device placement
AH-101 Assist handle	Assist handle
FK-514 Fax board	Super G3 fax, fax functionality for 1st and 2nd line
FK-515 Fax board	Super G3 fax, fax functionality for 3rd and 4th line
MK-742 Mount kit	Installation kit for FK-515
EK-608 USB I/F kit	USB keyboard connection
EK-609 USB I/F kit	USB keyboard connection, Bluetooth LE
SC-508 Security kit	Copy guard function
MK-735 Mount kit	Installation kit for ID card reader
AU-201S ID card authentication	Various ID card technologies
AU-102 Biometric authentication	Finger vein scanner
KH-102 Keyboard holder	To place USB keyboard
KP-101 10-Key pad	10-key
UK-212 Wireless LAN	Wireless LAN and wireless LAN Access Point Mode
UK-215 Wireless LAN	Wireless LAN and wireless LAN Simple Access Point Mode
HD-524 Hard disk mirroring kit	Back-up HDD
LK-102 v3 PDF enhancements	PDF/A, PDF encryption, digital signature
LK-104 v3 Voice guidance	Provides voice guidance functions
LK-105 v4 OCR text recognition	Searchable PDF and PPTX, PDF/A-1a
LK-106 Barcode fonts	Supports native barcode printing
LK-107 Unicode fonts	Supports native Unicode printing
LK-108 OCR A and B fonts	Supports native OCR A and B font printing
LK-110 v2 Document converter pack	Generates various file formats incl. DOCX, XLSX and PDF/A
LK-111 ThinPrint [®] Client	Print data compression for reduced network impact
LK-115 v2 TPM activation	Trusted Platform Module for protection of data encryption and decryption

- All specifications refer to A4-size paper of 80 gsm quality.
- The support and availability of the listed specifications and functionalities vary depending on operating systems, applications and network protocols as well as network and system configurations.
- Some of the product illustrations contain optional accessories.
- Specifications and accessories are based on the information available at the time of printing and are subject to change without notice.
- Konica Minolta does not warrant that any specifications mentioned will be error-free.
- All brand and product names may be registered trademarks or trademarks of their respective holders and are hereby acknowledged.

For more information please visit the bizhub Web site at <http://bt.konicaminolta.in/bizhub-558-458-product-overview/>

KONICA MINOLTA, the KONICA MINOLTA logo and symbol mark, "Giving Shape to Ideas", bizhub, bizhub PRO, bizhub PRESS, magicolor, PagePro, PageScope, Simitri, Simitri HD, Simitri HD+, Simitri with Biomass, Emperon, S.E.A.D., S.E.A.D.II, Printgroove and Konica Minolta Optimised Print Services and their respective logos are registered trademarks or trademarks of KONICA MINOLTA, INC. Evernote is a registered trademark or trademark of Evernote Corporation. SharePoint is a registered trademark or trademark of Microsoft Corporation in the U.S. and other countries. All other brands and product names are registered trademarks or trademarks of their respective companies or organisations.

Ecology & Environment

KONICA MINOLTA products are designed with the environment in mind.

- Energy Star
- RoHS Compliance
- WEEE Compliance
- Eco-friendly Toners



- Please read and follow the instruction manual to ensure safe operation.
- Only operate using appropriate power supply and voltage.
- Connecting the earth wire to an inappropriate place may cause explosion or electric shock. Please connect accordingly.



For more information: **SMS "KM OFFICE"** send to 52424 or Call: **1-800-266-2525**
Konica Minolta Business Solutions India Pvt. Ltd. : 10th Floor, Building No.8, Tower C,
 DLF Cyber City, Phase II Gurgaon, Haryana - 122002, India. Board No. +91-124 6652000.
 URL: www.konicaminolta.in, marcom@bin.konicaminolta.in | Konica Minolta Inc., Tokyo, Japan.

Connect with us :

Contact Point: